

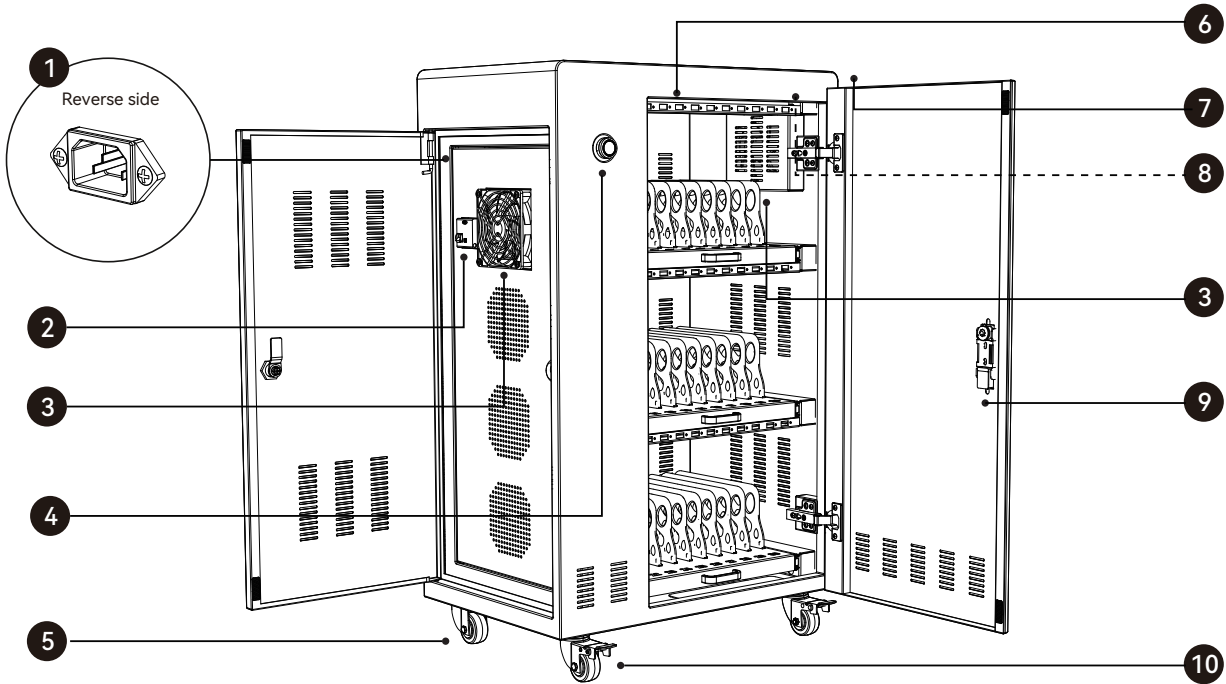

Overview



- 1. Power Interface
- 2. Leakage Protective Switch
- 3. Cooling fan
- 4. Power Switch
- 5. Stand wheel

- 6. USB Charging Interface
- 7. Handles(optional)
- 8. LED Indicator
- 9. Cabinet Locker
- 10. Stand Wheel with lock

- Package Contents
 AC Power Cord x1
 Charging cables match the capacity of the cart
 Instruction Booklet x1

Using the Charging Cart

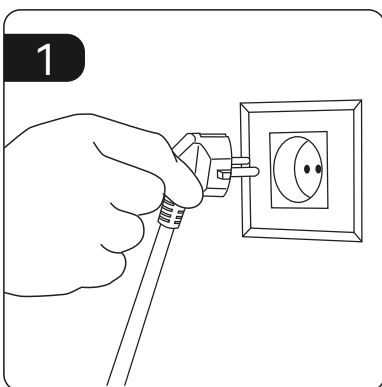

1 Plug in the power cord of the charging cabinet ;

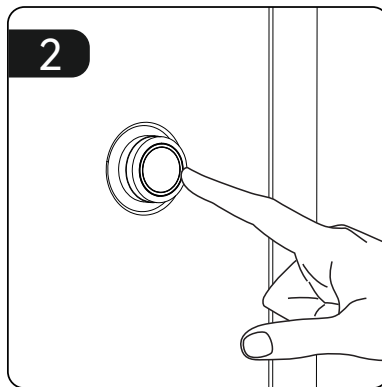

2 Turn on the power

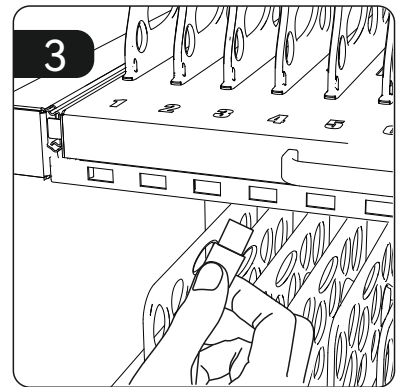

3 Connect the devices to the charging ports with the USB charging cables.

Charging indicator:

● Charging

● Charging completed/waiting to be charged

Matters needing attention

Product Specs



Model	QP-R10TA	QP-R20TA	QP-R30TA	QP-R40TA	QP-R52TA	QP-R60TA	QP-R65TA
Capacity	10	20	30	40	52	60	65
Input Voltage	220V/110V	220V/110V	220V/110V	220V/110V	220V/110V	220V/110V	220V/110V
Outage Voltage	5V/2.4A*10USB	5V/2.4A*20USB	5V/2.4A*30USB	5V/2.4A*40USB	5V/2.4A*52USB	5V/2.4A*60USB	5V/2.4A*65USB
Pated Power	200W	300W	400W	600W	600W	800W	800W
Product Size	540*390*330mm	556*400*665mm	556*400*920mm	556*400*1195mm	650*400*1195mm	650*400*1450mm	650*400*1450mm
Package Size	610*470*410mm	630*470*735mm	630*470*990mm	630*470*1260mm	720*470*1260mm	720*470*1510mm	720*470*1510mm
Net Weight	15kg	31kg	44kg	52kg	59kg	72kg	73kg
Gross Weight	19kg	37kg	52kg	60kg	70kg	83kg	84kg

Safety and maintenance precautions

For long term storage , remember to unplug the power cord and cover the cabinet with a dust cover.

Tips :

Before start using this product, please read the instructions carefully Please strictly follow the instructions for installation, application and maintenance. We will not be responsible for any damage caused by the wrong operation. Only authorized staff can use the cabinet, and only professional maintainer can maintain the cabinet.



- Must ground lead

The power socket must be grounded to avoid electric leakage. The cabinet must be located in a suitable storage place.



- Avoid high temperature

In order to prolong the life cycle, avoid rain and direct sunlight. Do not store the cabinet next to the window.



- Avoid slope

The wheels must be locked to prevent any movement. Before moving, release the lock on the wheel.



- Avoid moisture

When cleaning, do not pour water or alcohol directly on the cabinet, liquids will damage the internal circuit.