

Code Lock Instructions

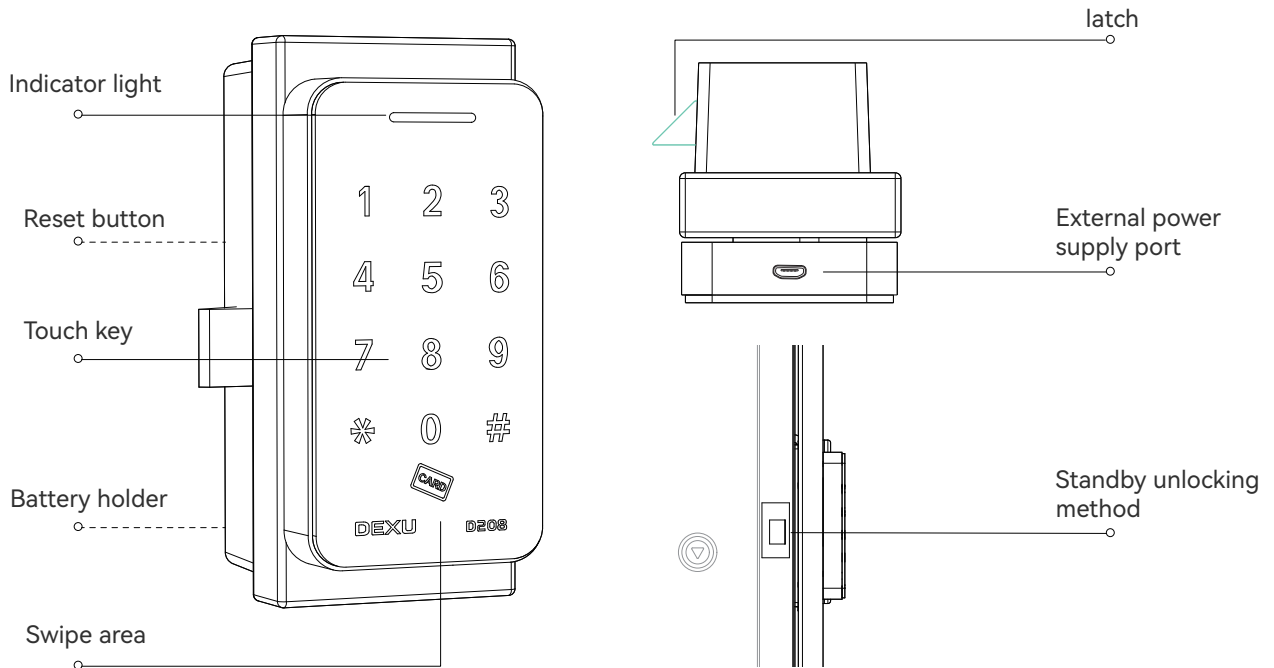

Operation instruction

Initial setup

First time using: default user code is "1111" and master code is "00000000", RF card is empty.

Default code for temporary unlock only, please change code in time. "*" is buttons to delete, "#" is buttons to confirm.

Password setting

1. Input 4~10 new digits new code (Input default code "1111" if no change), press "#" button to open unlock;
2. Green LED on if code correct, else flicker Yellow LED flickers;
3. Unlock and open the door out to open when Green LED on. Unlock: Input correct code, press "#" button, latch unlock when green LED on, open cabinet door. Lock: close cabinet door to lock.

Configure open card

Input #1#, LED flickers → Input master code → Press "#" button to confirm → Put the card close to the read read, then 2 beeps, LED on (light) long time once, card configuration succeed; LED continuously flicker, repeat this operation to configure new FR card; It can configure 20 pcs RF card at most (Remark: User unlock with RF card in private mode won't delete user code, but it will delete the user code in public mode)

Operation tips

- Initialization setting (Return to default setting): Keep pressing UV button on the smart switch panel for 5s, Red LED and Blue LED alternating flickers, then 2 beeps, system initialized;
- Code protect: Continuous input incorrect code 3 times, system will lock for 1 min, at this time any operation doesn't work;
- Alarm for low power: When power is low, Red LED will flicker and with 4 groups alarm sound, lock can only be unlocked about 100 times after alarm, suggest exchange batteries as soon as possible;
- If lock batteries out of working, please plug in to supply power to the battery to have enough electricity to unlock.
- When the door lock has no power, and there is no condition to power the door lock, please open the side door with the key, and press the spare unlocking hole to unlock the cabinet door.