

# Charging Cart Manual

## Overview

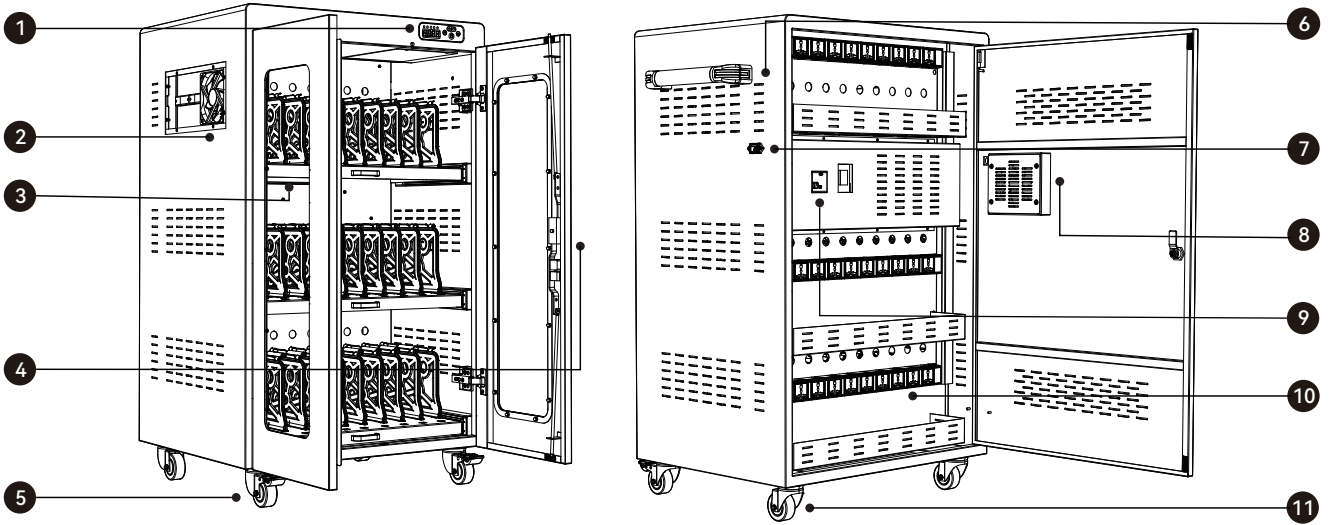

- 1. Switch
- 2. Cooling fan
- 3. UV disinfection lamp
- 4. Cabinet Lock
- 5. Stand Wheel with lock
- 6. handle(optional)
- 7. Power Interface
- 8. Cooling fan
- 9. Leakage Protective Switch
- 10. PDU AC port
- 11. Stand Wheel

## Using the Charging Cart

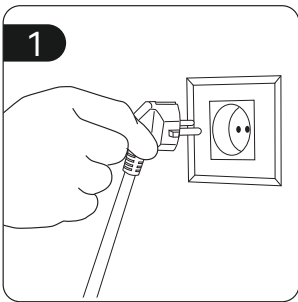

Plug in the power cord into the charging cabinet ;

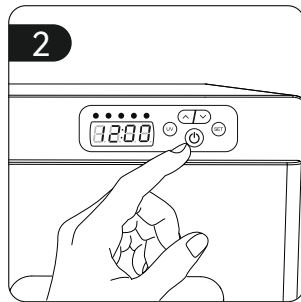

Green power switch and UV disinfection switch (Please refer to page 2)

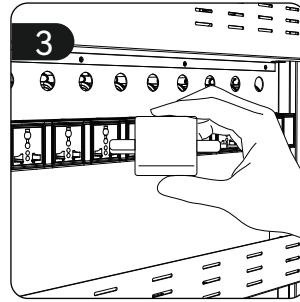

Plug the charger into the rear PDU socket .

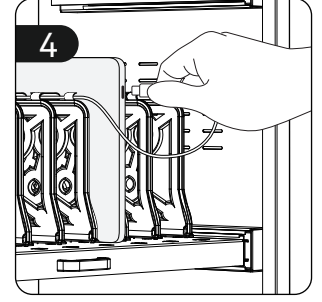

Connect the device to charge.

## Product Specs

Model	QP-R10TC	QP-R20TC	QP-R30TC	QP-R40TC
Charging Numbers	10	20	30	40
Input Voltage	220V/110V	220V/110V	220V/110V	220V/110V
Outage Voltage	220V/110V	220V/110V	220V/110V	220V/110V
Pated Power	2200W	2200W	2200W	2200W
Product Size	665*550*470mm	665*550*795mm	665*550*1115mm	665*550*1395mm
Package Size	740*640*530mm	740*640*850mm	740*640*1180mm	740*640*1470mm
Net Weight	35kg	49kg	69kg	84kg
Gross Weight	40kg	58kg	79kg	95kg

# Charging Cart Manual

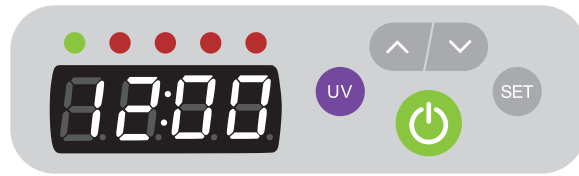

- **Charging power switch:**

Lightly touch the power source switch key, the charging cabinet into the charging state; When the LED light on the cabinet turns green, it means charging. The LED turns off before charging and finish charging.

- **UV-C disinfection setting:**

Lightly touch the UV key and press once to disinfect for 5 minutes, twice for 10 minutes, and three times for 15 minutes. Long press the UV key for 3 seconds to stop disinfection. Open the front door disinfection automatically extinguished.

- **Local time setting:**

Long press the SET key for three seconds to enter. When the clock/minute flickers, you can adjust the format (hr: min) by the up and down key. Press SET to confirm after setting.

- **Function key lock:**

Long press the up button for 3-4 seconds, hear the sound "di, di, di", all keys are locked at this time. If you need to release the lock, long press the up key again for 3-4 seconds and hear three "di" sound. That is, release the lock.

- **SET charging time /P delay start time: (SET= Setting up= confirm) :**

1. Press SET key, enter the delay-start up Settings interface, the order is: C =Set the total timing duration → P =set delay the start time duration → SET key save and exit.

2. P =delay the start time duration, are total of 5 gears for choosing, respectively P00 = 5s, P15M, P30M, P45M, P90M ( larger power, to choose larger P gear, and the smaller the vice versa )

Example: QP-R40TC instructions: (the charging factory default setting C timing total duration is 8H, delay start gear default is P30M) Lightly touch the main switch, the whole process of the program execution is: the first row is opened immediately, and maintain continuous charging state, then the next row start charging after the last row charging for 30 minutes, and maintains the charging state all the time. The total duration of the time is 8 hours, and all the four channels close the output to complete a charging process. Open again according to the last set of the program automatically operate, no need to repeat the setting. Storage and charging state, the total time of the timer is full in 8 hours, and the output of all four channels is closed to complete a charging process. Open again according to the last set of the program automatically run, no need to repeat the setting.

Timing set	Layer 1 delayed start time	Layer 2 delayed start time	Layer 3 delayed start time	Layer 4 delayed start time
P00	0	5s	10s	15s
P15	0	15M	30M	45M
P30	0	30M	1H	1.5H
P45	0	45M	1.5H	2.15H
P90	0	1.5H	3H	4.5H

Don't directly plug in the electric appliance, please operate according to the instructions before use.

1. The AC power cord of the cabinet is connected with the wall socket reliably and is well grounded before using.

(It is strictly prohibited to connect the cabinet to charge by means of removable row insertion and conversion.)

2. The factory default gear P = 30M can support below 45W equipment, as for above 65W equipment, please select: above P45M gear.

## Safety precautions Before Use and Maintenance

Please check and confirm the following conditions before operation

- Power outlet must connect with the ground to avoid electric leakage.
- The cabinet must be located in a suitable storage. The wheels must be locked to avoid any movement.
- In order to prolong life cycle, avoid rain and direct sunlight. Do not store the Cabinet next to Window.
- Before moving, release the lock on the wheels.
- Avoid pouring the water or alcohol directly onto the cabinet when cleaning. Liquid damage internal circuits.
- For long term storage, remember to unplug the power cable and put a dust Cover over the Cabinet.
- Only qualified personnels are permitted to service the cabinet. Always unplug power cable before proceeding.



Must ground lead



Avoid slope



Avoid high temperature



Avoid moisture