

# Charging Cart Manual

## Overview

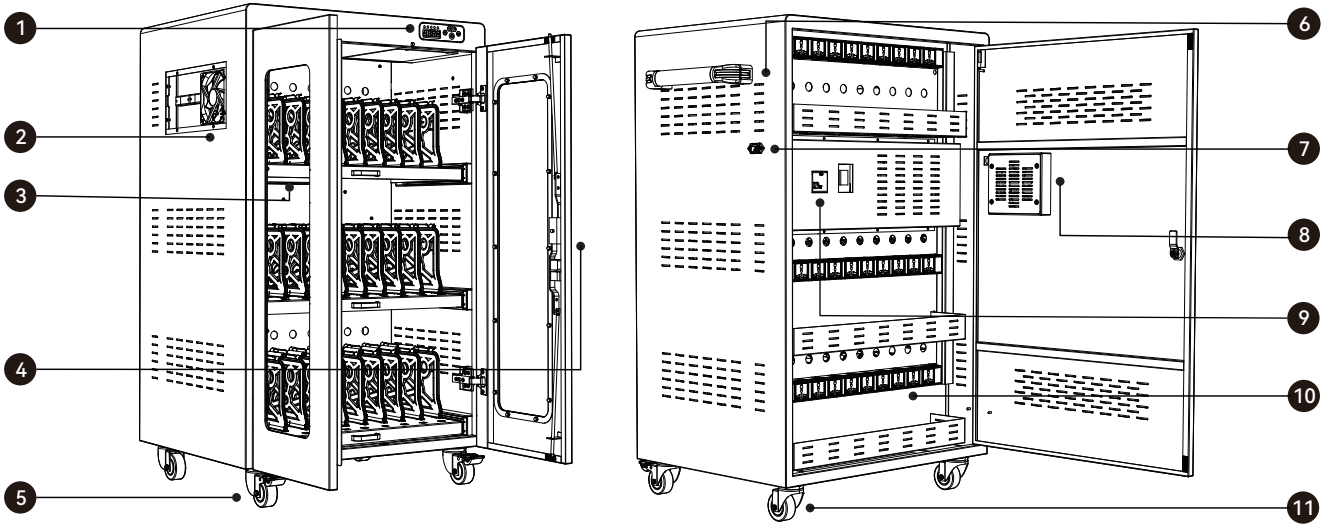

- |                         |                          |                              |
|-------------------------|--------------------------|------------------------------|
| 1. Switch               | 5. Stand Wheel with lock | 9. Leakage Protective Switch |
| 2. Cooling fan          | 6. Handle(optional)      | 10. PDU AC port              |
| 3. UV disinfection lamp | 7. Power Interface       | 11. Stand Wheel              |
| 4. Cabinet Lock         | 8. Cooling fan           |                              |

## Using the Charging Cart

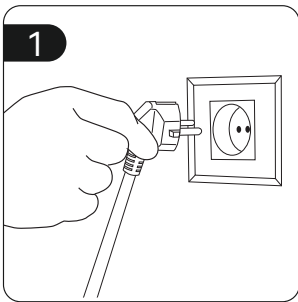

1 Plug in the power cord into the charging cabinet ;

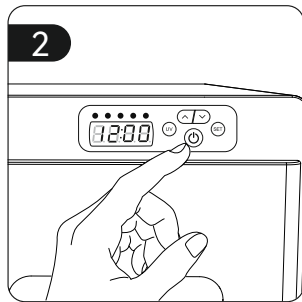

2 Green power switch and UV disinfection switch (Please refer to page 2)

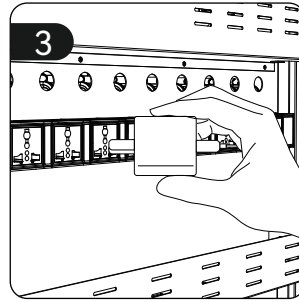

3 Plug the charger into the rear PDU socket .

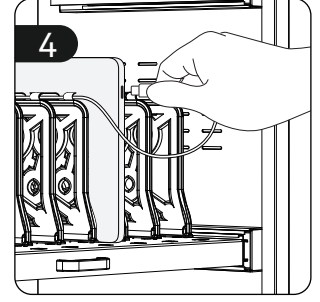

4 Connect the device to charge.

## Product Specs

Model	QP-R10TC	QP-R20TC	QP-R30TC	QP-R40TC
Charging Numbers	10	20	30	40
Input Voltage	220V/110V	220V/110V	220V/110V	220V/110V
Outage Voltage	220V/110V	220V/110V	220V/110V	220V/110V
Pated Power	2200W	2200W	2200W	2200W
Product Size	665*550*470mm	665*550*795mm	665*550*1115mm	665*550*1395mm
Package Size	740*640*530mm	740*640*850mm	740*640*1180mm	740*640*1470mm
Net Weight	35kg	49kg	69kg	84kg
Gross Weight	40kg	58kg	79kg	95kg

# Smart Digital Control Panel

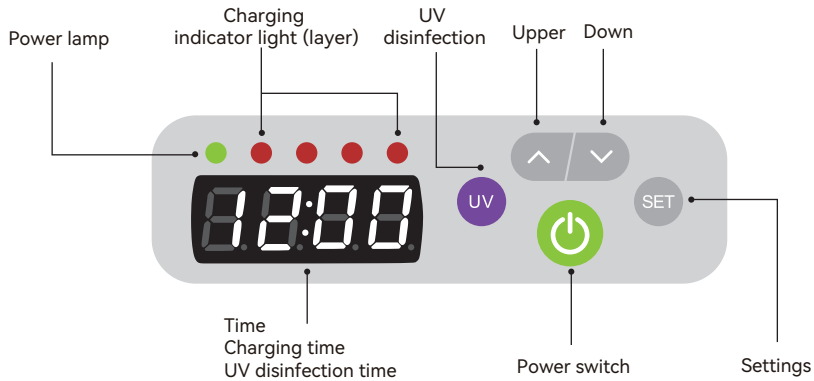

- **Intelligent Current Stabilization System**

Click the power button, the system performs a self-check, and then charges layer by layer until all devices are fully charged; red light indicates charging, and green light indicates fully charged or standby status.

- **UV-C disinfection setting**

The UV disinfection button has three settings: single press for 5-minute disinfection, double press for 10 minutes, and triple press for 15 minutes. Press to start, and hold to turn off.

- **Charging setting**

Please press power button, it will start to work.

- **Countdown charging**

Please press SET key, C means charging. The number means the charging time Press the Set key to make it take effect.

Example C05 means, 5 hours off charging ;  
C08 means, 8 hours off charging ;

- **Child lock setting**

Long press the UP key for 4 seconds, you can hear the "beep" sound, and the child lock will take effect.

- **Local time setting**

Long press the setting key, when the number flashes, you can press the up/down key to adjust, after the setting, press the setting key to confirm.

- **Cooling fan**

The heating fan will automatically start when the power is turned on

- **Set up Wi-Fi (optional)**

Press and hold the up key and the Set key to enter Wi-Fi setup.

## Safety and maintenance precautions

For long term storage , remember to unplug the power cord and cover the cabinet with a dust cover.



### Tips :

Before start using this product, please read the instructions carefully Please strictly follow the instructions for installation, application and maintenance.We will not be responsible for any damage caused by the wrong operation.

Only authorized staff can use the cabinet, and only professional maintainer can maintain the cabinet.



- **Must ground lead**

The power socket must be grounded to avoid electric leakage. The cabinet must be located in a suitable storage place.



- **Avoid slope**

The wheels must be locked to prevent any movement. Before moving, release the lock on the wheel.



- **Avoid high temperature**

In order to prolong the life cycle, avoid rain and direct sunlight. Do not store the cabinet next to the window.



- **Avoid moisture**

When cleaning, do not pour water or alcohol directly on the cabinet, liquids will damage the internal circuit.